



DE
Enquiry
25183

METROPOLITAN BOROUGH OF BURY
ENVIRONMENT AND DEVELOPMENT SERVICES
FORM OF APPLICATION FOR MODIFICATION ORDER
WILDLIFE AND COUNTRYSIDE ACT 1981
DEFINITIVE MAP AND STATEMENT OF BURY DISTRICT

To: Metropolitan Borough of Bury
Environment and Development Services
Engineering Division
Lester House
21 Broad Street
Bury BL9 0AW

X We (name of applicant)
of (address of applicant)



hereby apply for an order under Section 53(2) of the Wildlife and Countryside Act 1981 modifying the Definitive Map and Statements for the area by:

- Deleting the *(footpath) (bridleway) (byway open to traffic)
from
to
NOT APPLICABLE
- Adding the *(footpath) (bridleway) (byway open to traffic)
from WATLING STREET, BURY
to MILE LANE, BURY
- *(Upgrading) (downgrading) to a *(footpath) (bridleway) (byway open to all traffic)
from
to
NOT APPLICABLE

4. *(Varying) (adding to) the particulars relating to the *(footpath) (bridleway) (byway open to all traffic)

from

to

by providing that

and shown on the map annexed hereto.

NOT APPLICABLE

We attached copies of the following documentary evidence (including statements of witnesses) in support of this application.

* [REDACTED] STATEMENTS OF WITNESSES' PREVIOUSLY SUBMITTED TO BURY M.B.C.

Dated this 16TH day of FEBRUARY 2009

Signed [REDACTED]

* Delete where necessary

[REDACTED] AND [REDACTED] ARE THE CONTACTS REPRESENTING THE [REDACTED] RESIDENTS WHO RETURNED TO BURY M.B.C. EVIDENCE FORMS REGARDING THE APPLICATION FOR A PUBLIC FOOTPATH TO BE ADDED TO THE DEFINITIVE MAP AND STATEMENT

(Form A)
Schedule 7

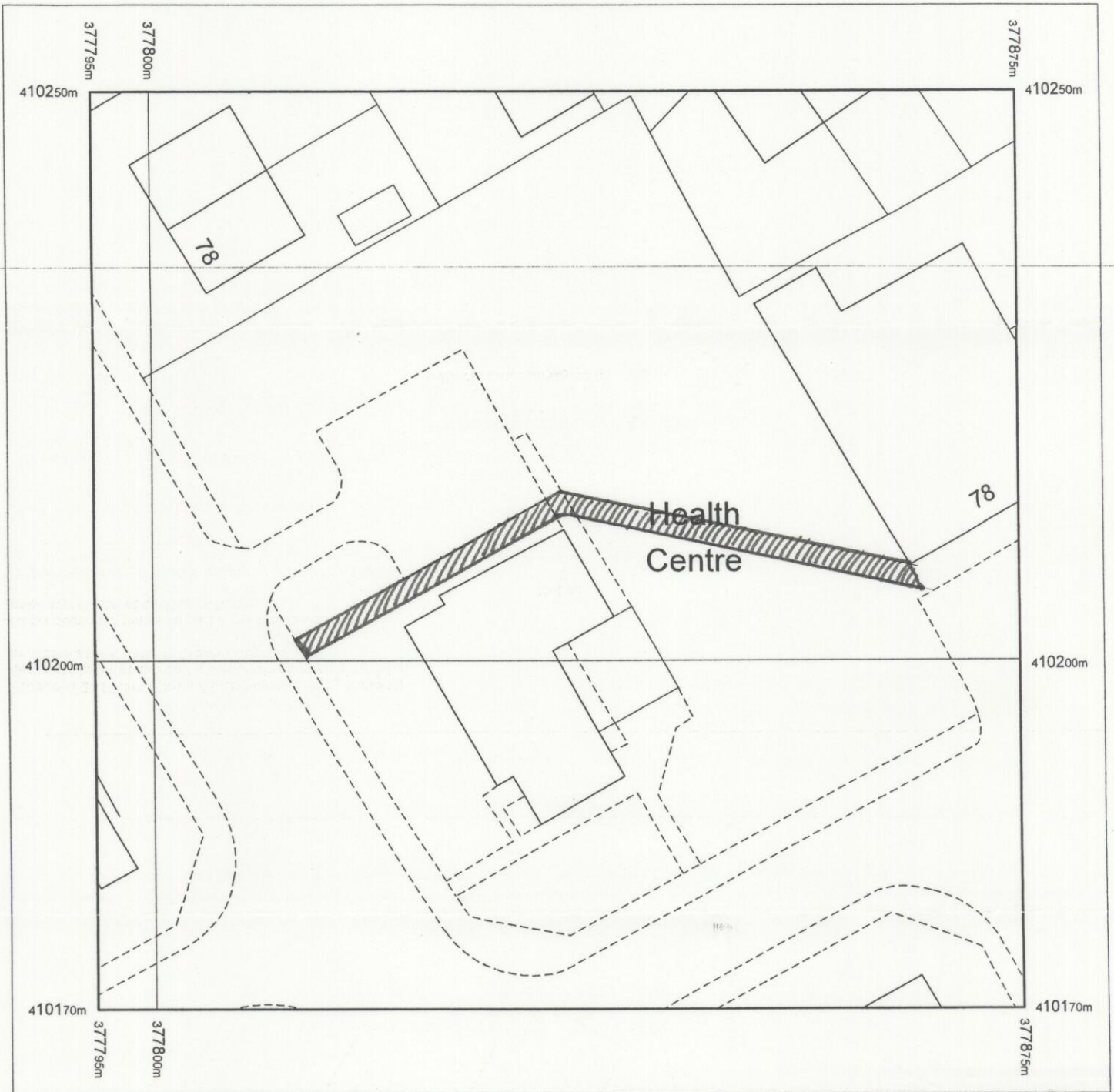

Produced 27.01.2009 from the Ordnance Survey National Geographic Database and incorporating surveyed revision available at this date. © Crown Copyright 2009.

Reproduction in whole or part is prohibited without the prior permission of Ordnance Survey.

Ordnance Survey, the OS Symbol and OS Sitemap are registered trademarks of Ordnance Survey, the national mapping agency of Great Britain.

The representation of a road, track or path is no evidence of a right of way.

The representation of features as lines is no evidence of a property boundary.

Part or all of this OS Sitemap is enlarged from mapping produced at one or more of the following scales: 1:1250, 1:2500, 1:10000.

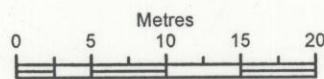

Scale 1:500

Supplied by: **Entwistle Manchester**
Serial number: 00062800
Centre coordinates: 377835 410209.63

Further information can be found on the OS Sitemap Information leaflet or the Ordnance Survey web site:
www.ordnancesurvey.co.uk