

## Highway Winter Service

Footway Treatment Market Street – phase 1

Area team – Bury East

(Textural description)

Street Name	Description	Phase	Footway length (m)
Angouleme Way/Market street	Junction	1	34
Market Street	Angouleme Way to College Entrance	1	317
		<b>Total:</b>	<b>351</b>

(Plan)

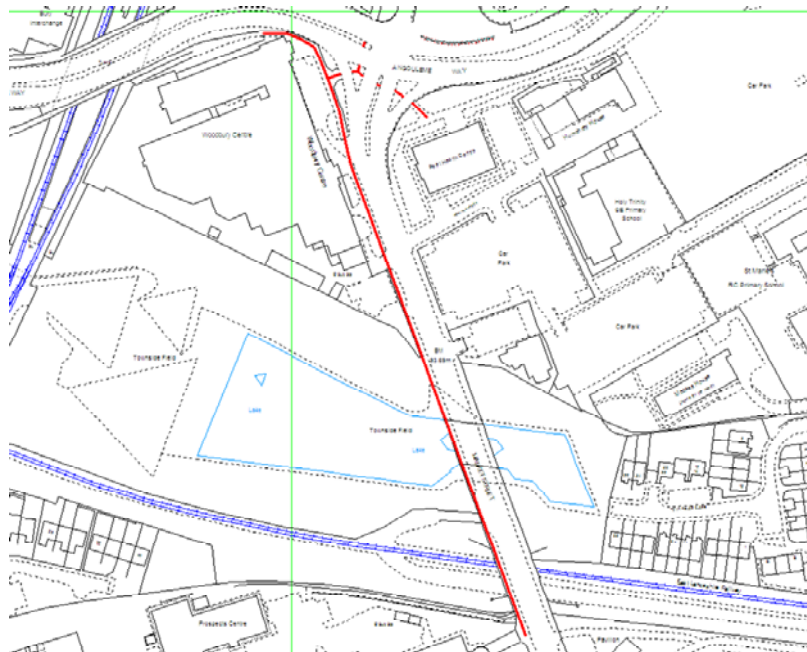

## Highway Winter Service

Footway Treatment Market Subway Slopes and Steps – Phase 2  
Area team – Bury East

(Textural description)

Street Name	Description	Phase	Footway Length (m)
Angouleme Way	Open Market Subway	2	62
Angouleme Way	Market Hall Subway	2	91
		<b>Total:</b>	<b>156</b>

(Plan)

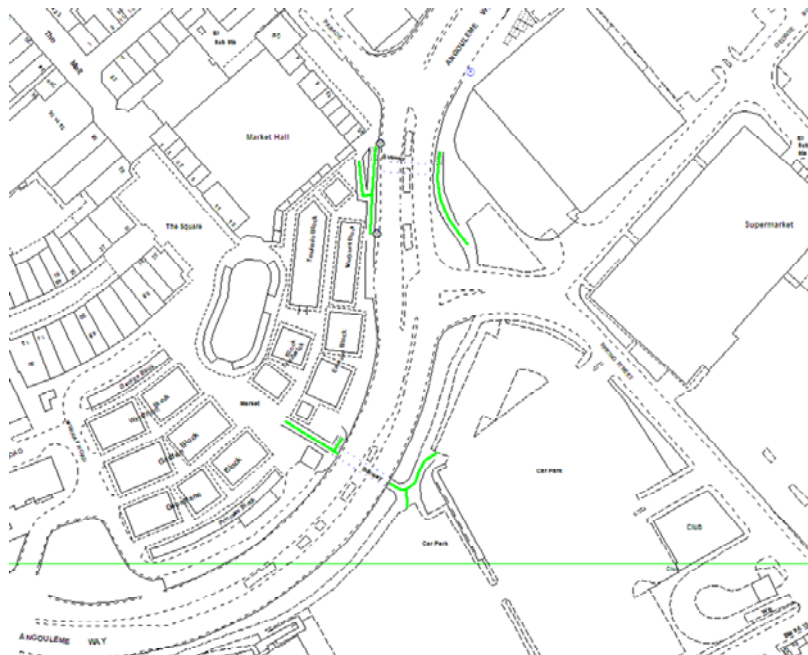

## Highway Winter Service

Footway Treatment Parkhills Road – Phase 2

Area team – Bury East

(Textural description)

Street Name	Description	Phase	Footway Length (m)
Parkhills Road	Back Parkhills Road South to Back Brierley Street	2	61
		<b>Total:</b>	<b>61</b>

(Plan)



Highway Winter Service

Footway Treatment Rochdale Road – Phase 1  
Area team – Bury East

(Textural description)

Street Name	Description	Phase	Footway length (m)
Rochdale Road	York Street to Bond Street	1	264
		Total:	264

(Plan)

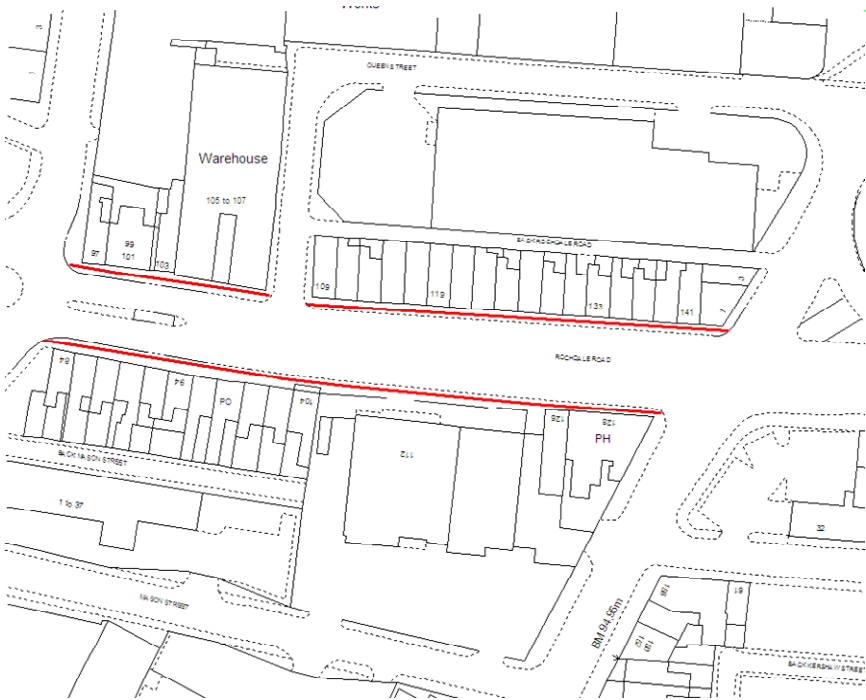

## Highway Winter Service

Footway Treatment the Rock, Side Streets and Market Place –  
Phase 1

Area team – Bury East

(Textural description)

Street Name	Description	Phase	Footway Length (m)
Crompton Street	The Rock to Precinct Entrance	1	184
Cross Street	The Rock to Precinct and Multi Storey car park entrance	1	128
Cross Street	Precinct and Multi Storey Car Park entrances to Angouleme Way	1	185
Eden Street	The Rock to Parsons Lane Car Park	1	45
Market Place	Market Place	1	215
Peel Way	School Brow to Tesco crossing	1	22
School Brow	Tithebarn Street to Peel Way crossing	1	193
The Rock	The Wylde to Wilkinson's (north side) & the Rock Car Park entrance (south side)	1	943
Tithebarn Street	The Rock to School Brow (mostly west side only)	1	74
Union Street	The Rock to Precinct entrance	1	80
		<b>Total:</b>	<b>2069</b>

(Plan)



Highway Winter Service

Footway Treatment Walmersley Road – Phase 2  
Area team – Bury East

(Textural description)

Street Name	Description	Phase	Footway Length (m)
Walmersley Road	Fox Street to Topping Street	2	176
		Total:	176

(Plan)

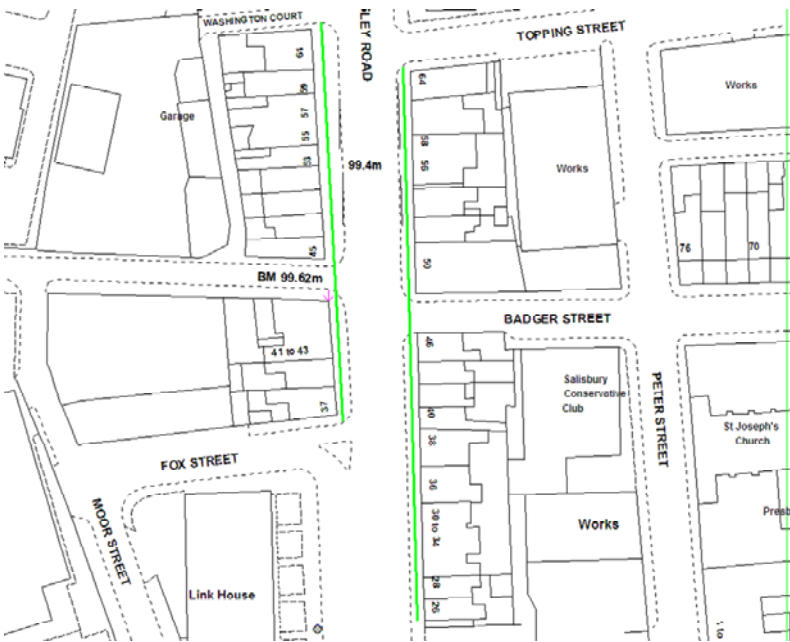

## Highway Winter Service

Footway Treatment Bolton Street to Knowsley Street – Phase 1  
Area team – Bury Town Centre

(Textural description)

Street Name	Description	Phase	Footway Length (m)
Back Market Street	Angouleme Way to Princess Parade	1	71
Bank Street	Steps to Bolton Street Car Park	1	17
Bolton Street	Market Place to Snooker Club	1	409
Broad Street	Silver Street to Haymarket Street	1	180
Haymarket Street	Market Street to angouleme Way	1	414
Kay Gardens	Adjacent to Bus/Metrolink Interchange	1	90
Knowsley Street	Angouleme Way to Manchester Road	1	560
Market Street	Market Place to Haymarket Street	1	270
Market Street	Haymarket Street to Princess Parade	1	138
Market Street	Interchange to Murray road	1	63
Princess Parade	Interchange to Murray road	1	91
Silver Street	Market Place to Moss Street	1	306
		<b>Total:</b>	<b>2609</b>

(Plan)

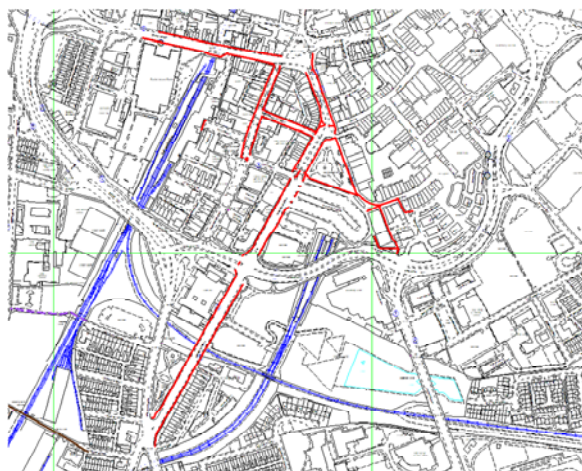



### Highway Winter Service

Footway Treatment Bolton Street to Knowsley Street – Phase 1  
Area team – Bury Town Centre

(Textural description)

Street Name	Description	Phase	Footway Length (m)
Angouleme Way	Bury College Subway Ramp	2	78
Angouleme Way	Interchange Subway Slopes (north)	2	212
Bank Street	Silver Street to Craig House	2	96
Manchester Road	Moss Street to Angouleme Way	2	273
Moss Street	Silver Street to Haymarket Street	2	143
		<b>Total:</b>	<b>802</b>

(Plan)

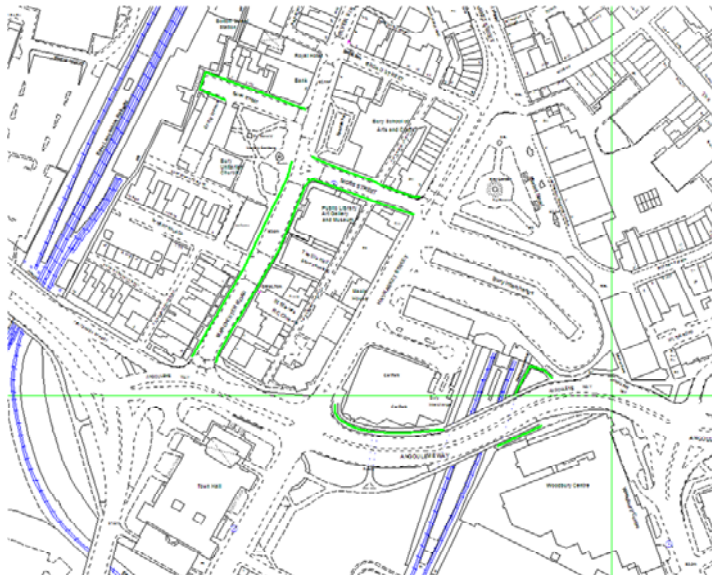



Highway Winter Service

Footway Treatment Bolton Street to Knowsley Street – Phase 1  
Area team – Bury West

(Textural description)

Street Name	Description	Phase	Footway Length (m)
Bolton Road	No.5 to Fountain Street	2	481
		<b>Total:</b>	481

(Plan)

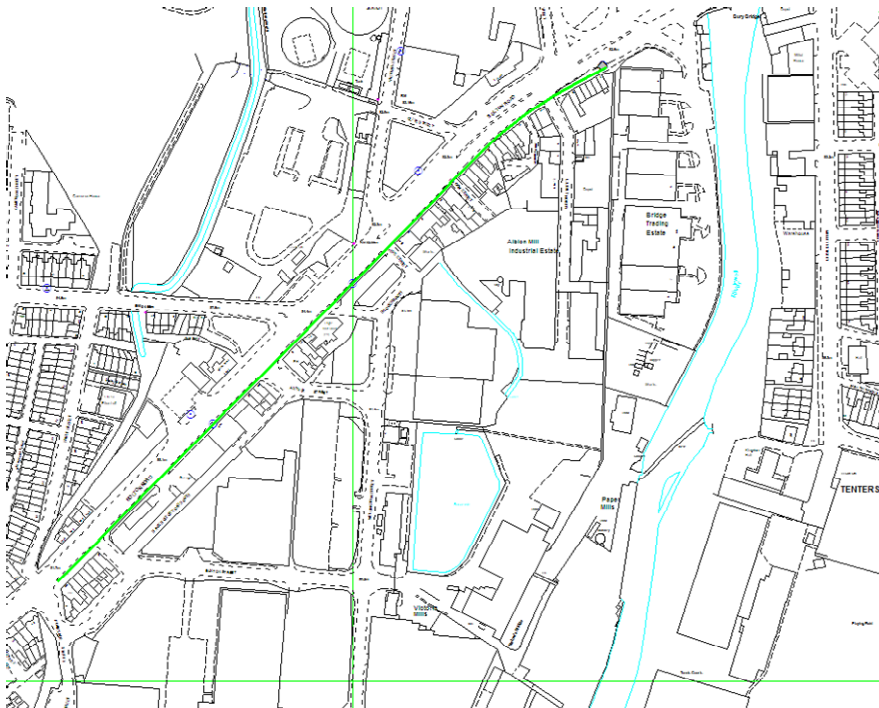

## Highway Winter Service

Footway Treatment Church Street Ainsworth – Phase 2

Area team – Bury West

(Textural description)

Street Name	Description	Phase	Footway Length (m)
Church Street	Bradley Fold Road to Knowsley Road	2	103
		<b>Total:</b>	<b>103</b>

(Plan)



## Highway Winter Service

Footway Treatment Interchange to Schools – Phase 1  
Area team – Bury West

(Textural description)

Street Name	Description	Phase	Footway Length (m)
Angouleme Way	Haymarket Street to Tenterden Street	1	201
Belle Vue Terrace	Footway over railway end of Belle Vue Terrace	1	43
Belle Vue Terrace	Manchester Road to railway bridge (north side only)	1	106
Bridge Road	Tenterden Street to Bury Grammar School (both sides) & St Gabriels (west side only)	1	517
Jubilee Way	Tenterden Street Subway	1	83
Jubilee Way	Angouleme Way to Tenterden Street	1	363
Manchester Road	Jubilee Way to Baron Street	1	607
Tenterden Street	Jubilee Way to Bridge Road (south side)	1	86
		<b>Total:</b>	<b>2006</b>

(Plan)

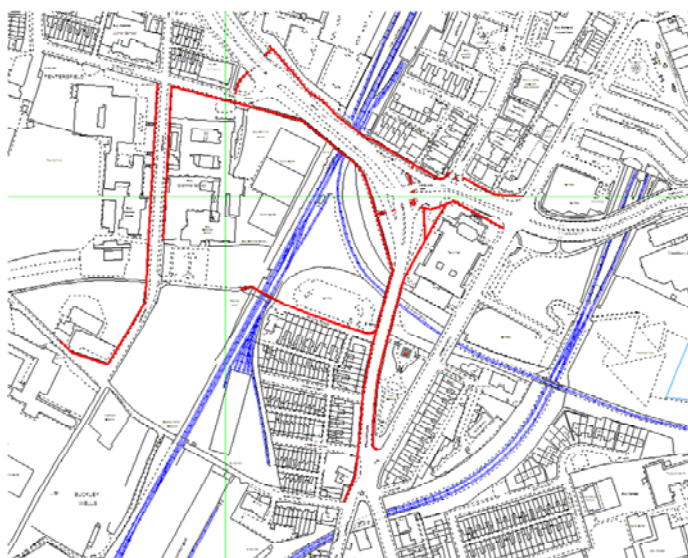

Highway Winter Service

Footway Treatment Tottington Road – Phase 2  
Area team – Bury West

(Textural description)

Street Name	Description	Phase	Footway Length (m)
Tottington Road	Mill Lane to Elson Street	2	121
		Total:	121

(Plan)

