

DO NOT SCALE

- NOTES:**
- ALL DIMENSIONS GIVEN ARE SHOWN IN METRES UNLESS OTHERWISE SPECIFIED.
 - CONCEPT DESIGN HAS BEEN COMPLETED BASED ON OS MAPPING AND SITE OBSERVATIONS ONLY. DESIGN SUBJECT TO CHANGE UPON TOPOGRAPHICAL AND OTHER SURVEY INFORMATION ACQUISITION AS DESIGN MOVES TO NEXT STAGE.
 - TRAFFIC MODELING NOT YET UNDERTAKEN.
 - REFRESH OF EXISTING ROAD MARKINGS, FORMALISED PARKING BAYS, TROs AND TACTILE PAVING TO BE ASSESSED AT A LATER DESIGN STAGE.

- KEY:**
- EXISTING KERB LINE
 - EXISTING ROAD MARKING
 - PROPOSED KERB LINE
 - PROPOSED WHITE LINE MARKING
 - PROPOSED WHITE LINE MARKING / DEMARCATION BLOCKS TO PROVIDE SEGREGATION BETWEEN CYCLISTS / PEDESTRIANS
 - PROPOSED TRAMLINE PAVING
 - PROPOSED LADDER PAVING
 - PROPOSED RAMP
 - PROPOSED RED (CONTROLLED) TACTILE PAVING
 - PROPOSED BUFF (UNCONTROLLED) TACTILE PAVING
 - PROPOSED SHARED USE PATH
 - PROPOSED SEGREGATED CYCLEWAY
 - PROPOSED WIDENING OR NARROWING OF EXISTING FOOTWAY
 - PROPOSED TRAFFIC ISLAND
 - EXISTING SHARED USE PATH TO BE RETAINED
 - EXISTING FOOTWAY TO BE RETAINED
 - EXISTING CARRIAGEWAY
 - PROPOSED RAISED TABLE
 - AREA OF PLACEMAKING OPPORTUNITY

REV	DATE	BY	DESCRIPTION	CHK	APP
P09	02/12/2025	KT	DESIGN UPDATES	JK	PJ
P08	15/10/2025	KT	DRP ISSUE	JK	KT
P07	15/09/2025	JK	UPDATED FOLLOWING CLIENT COMMENT	PJ	PJ
P06	12/09/2025	VC	UPDATED FOLLOWING CLIENT COMMENT	JK	PJ
P05	04/07/2025	KT	UPDATED FOLLOWING INTERNAL DRP	JK	PJ
P04	08/06/2025	KT	UPDATED FOLLOWING DRP COMMENT	JK	PJ
P03	21/02/2025	JK	UPDATED FOLLOWING CLIENT COMMENT	PJ	PJ
P02	20/12/2024	JK	UPDATED FOLLOWING CLIENT COMMENT	PJ	PJ
P01	04/12/2024	VG	FIRST ISSUE	JK	PJ

DRAWING STATUS: **S2 - FOR INFORMATION**

The Mailbox, Level 2, 100 Wharfedale Street, Birmingham, B1 1RT, UK
T+ 44 (0) 121 352 4700, F+ 44 (0) 121 352 4701
wsp.com

SITE/PROJECT: BURY ACTIVE TRAVEL CONCEPT DESIGN DEVELOPMENT

TITLE: BURY TOWN CENTRE CASTLECROFT ROAD CYCLE IMPROVEMENTS SHEET 03 OF 05

SCALE @ A1:	1:500	CHECKED:	JK	APPROVED:	PJ
PROJECT NO:	UK0028352.8493	DESIGNED:	KT	DRAWN:	VC
DRAWING NO:	28352.8493-WSP-XX-WG-DR-LP-0003	DATE:	December 25	REV:	P09

© WSP UK Ltd

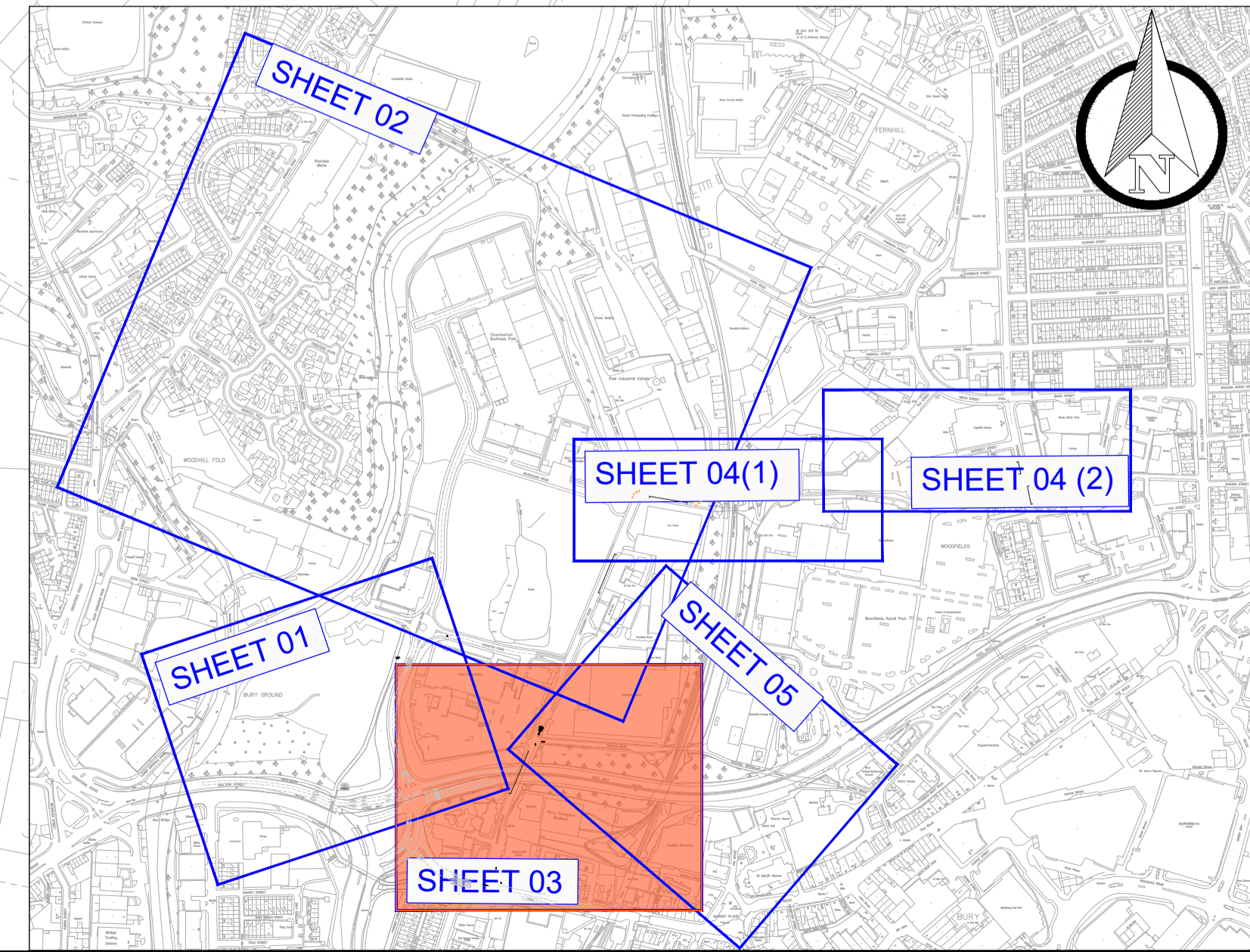

File name: C:\Users\jw005555\OneDrive\Documents\28352.8493-WSP-XX-WG-DR-LP-0003.DWG, printed on 04 December 2025, 21:11:01, by jw005555

DO NOT SCALE

NOTES:

1. ALL DIMENSIONS GIVEN ARE SHOWN IN METRES UNLESS OTHERWISE SPECIFIED.
2. CONCEPT DESIGN HAS BEEN COMPLETED BASED ON OS MAPPING AND SITE OBSERVATIONS ONLY. DESIGN SUBJECT TO CHANGE UPON TOPOGRAPHICAL AND OTHER SURVEY INFORMATION ACQUISITION AS DESIGN MOVES TO NEXT STAGE.
3. TRAFFIC MODELING NOT YET UNDERTAKEN.
4. REFRESH OF EXISTING ROAD MARKINGS, FORMALISED PARKING BAYS, TROs AND TACTILE PAVING TO BE ASSESSED AT A LATER DESIGN STAGE.

KEY:

- EXISTING KERB LINE
- EXISTING ROAD MARKING
- PROPOSED KERB LINE
- PROPOSED WHITE LINE MARKING
- PROPOSED WHITE LINE MARKING / DEMARCATION BLOCKS TO PROVIDE SEGREGATION BETWEEN CYCLISTS / PEDESTRIANS
- PROPOSED TRAMLINE PAVING
- PROPOSED LADDER PAVING
- PROPOSED RAMP
- PROPOSED RED (CONTROLLED) TACTILE PAVING
- PROPOSED BUFF (UNCONTROLLED) TACTILE PAVING
- PROPOSED SHARED USE PATH
- PROPOSED SEGREGATED CYCLEWAY
- PROPOSED WIDENING OR NARROWING OF EXISTING FOOTWAY
- PROPOSED TRAFFIC ISLAND
- EXISTING SHARED USE PATH TO BE RETAINED
- EXISTING FOOTWAY TO BE RETAINED
- EXISTING CARRIAGEWAY
- PROPOSED RAISED TABLE
- AREA OF PLACEMAKING OPPORTUNITY

REV	DATE	BY	DESCRIPTION	CHK	APP
P09	09/12/2025	KT	DESIGN UPDATES	JK	PJ
P08	15/10/2025	KT	DRP ISSUE	JK	PJ
P07	15/09/2025	JK	UPDATED FOLLOWING CLIENT COMMENT	PJ	PJ
P06	12/09/2025	VC	UPDATED FOLLOWING CLIENT COMMENT	JK	PJ
P05	04/07/2025	KT	UPDATED FOLLOWING INTERNAL DRP	JK	PJ
P04	09/06/2025	KT	UPDATED FOLLOWING DRP COMMENT	JK	PJ
P03	21/02/2025	JK	UPDATED FOLLOWING CLIENT COMMENT	PJ	PJ
P02	20/12/2024	JK	UPDATED FOLLOWING CLIENT COMMENT	PJ	PJ
P01	04/12/2024	VG	FIRST ISSUE	JK	PJ

DRAWING STATUS: S2 - FOR INFORMATION



The Mailbox, Level 2, 100 Wharfedale Street, Birmingham, B1 1RT, UK
T+ 44 (0) 121 352 4700, F+ 44 (0) 121 352 4701
wsp.com



Bury
COUNCIL

SITE/PROJECT: BURY ACTIVE TRAVEL
CONCEPT DESIGN DEVELOPMENT

TITLE: BURY TOWN CENTRE
CHAMBERHALL STREET TO CHARLES STREET
CYCLE IMPROVEMENTS
SHEET 04 OF 05

SCALE @ A1:	CHECKED:	APPROVED:	
1:500	JK	PJ	
PROJECT NO:	DESIGNED:	DRAWN:	DATE:
UK0028352.8493	KT	VC	December 25
DRAWING NO:	REV:		
28352.8493-WSP-XX-WG-DR-LP-0004	P09		

© WSP UK Ltd

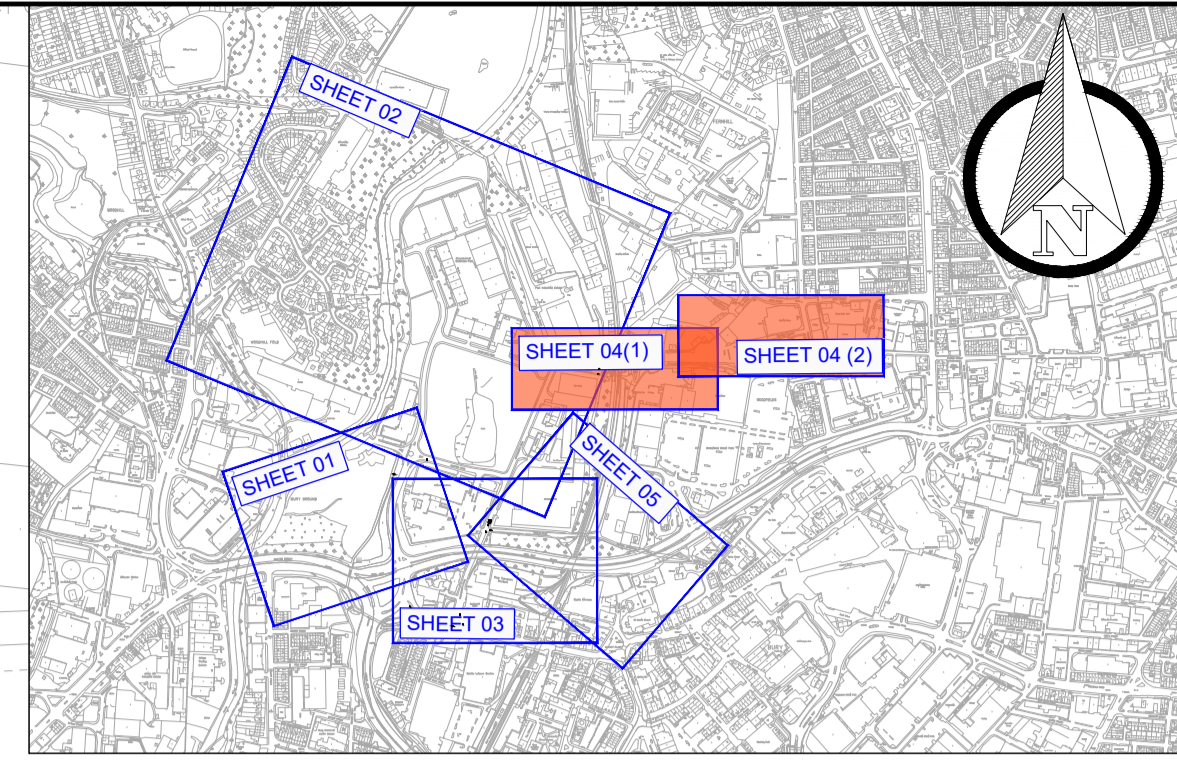
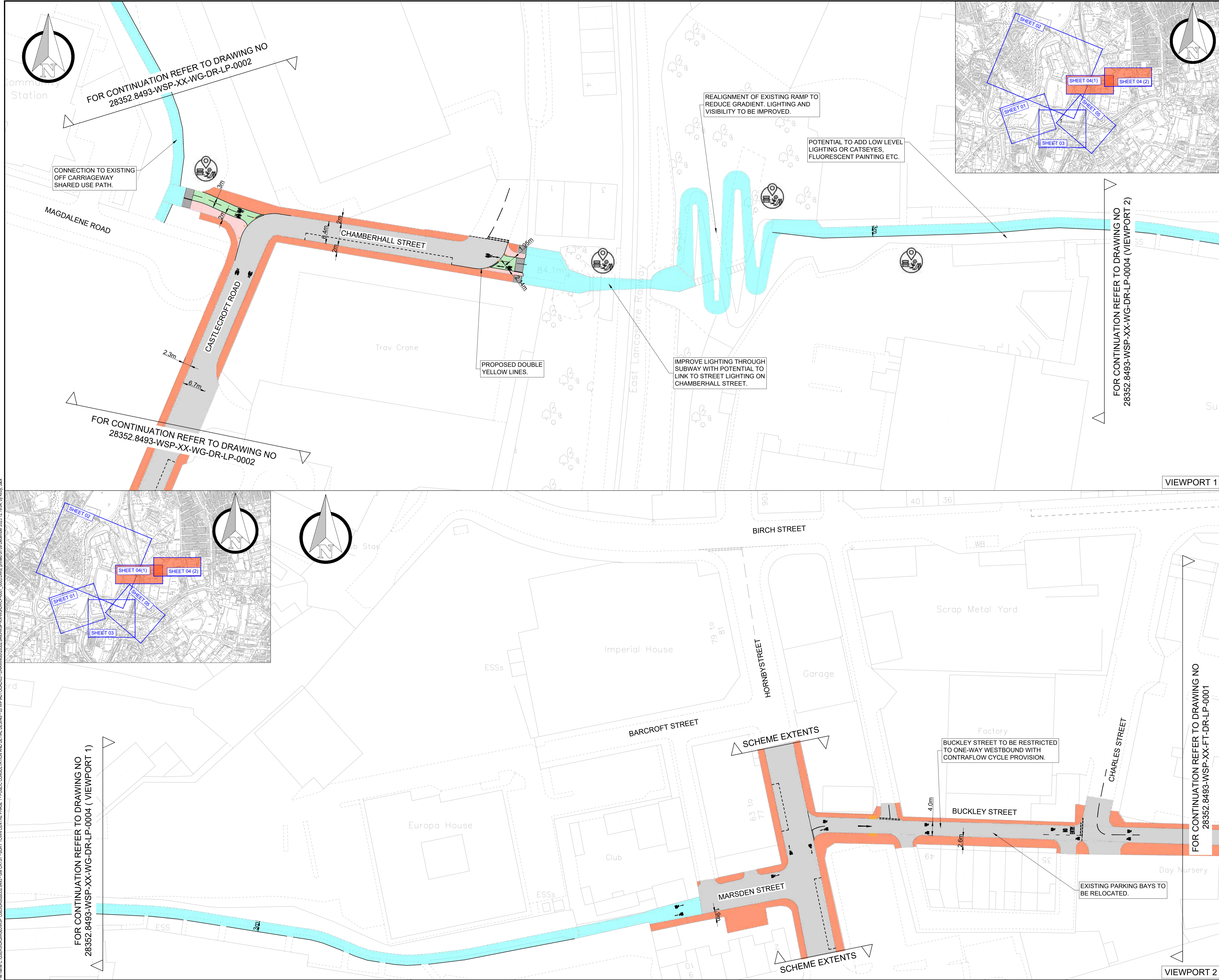

FOR CONTINUATION REFER TO DRAWING NO 28352.8493-WSP-XX-WG-DR-LP-0002

FOR CONTINUATION REFER TO DRAWING NO 28352.8493-WSP-XX-WG-DR-LP-0004 (VIEWPORT 1)

FOR CONTINUATION REFER TO DRAWING NO 28352.8493-WSP-XX-WG-DR-LP-0004 (VIEWPORT 2)

VIEWPORT 1

VIEWPORT 2

File name: C:\Users\uk0028352\OneDrive\Desktop\28352.8493-WSP-XX-WG-DR-LP-0001_0005.DWG, issued on: 09 December 2025, 12:19:04, by: Kev, .sxd
 File name: C:\Users\uk0028352\OneDrive\Desktop\28352.8493-WSP-XX-WG-DR-LP-0001_0005.DWG, issued on: 09 December 2025, 12:19:04, by: Kev, .sxd

DO NOT SCALE

NOTES:

1. ALL DIMENSIONS GIVEN ARE SHOWN IN METRES UNLESS OTHERWISE SPECIFIED.
2. CONCEPT DESIGN HAS BEEN COMPLETED BASED ON OS MAPPING AND SITE OBSERVATIONS ONLY. DESIGN SUBJECT TO CHANGE UPON TOPOGRAPHICAL AND OTHER SURVEY INFORMATION ACQUISITION AS DESIGN MOVES TO NEXT STAGE.
3. TRAFFIC MODELING NOT YET UNDERTAKEN.
4. REFRESH OF EXISTING ROAD MARKINGS, FORMALISED PARKING BAYS, TROs AND TACTILE PAVING TO BE ASSESSED AT A LATER DESIGN STAGE.

KEY:

- EXISTING KERB LINE
- EXISTING ROAD MARKING
- PROPOSED KERB LINE
- PROPOSED WHITE LINE MARKING
- PROPOSED WHITE LINE MARKING / DEMARCATION BLOCKS TO PROVIDE SEGREGATION BETWEEN CYCLISTS / PEDESTRIANS
- ▨ PROPOSED TRAMLINE PAVING
- ▨ PROPOSED LADDER PAVING
- ▨ PROPOSED RAMP
- ▨ PROPOSED RED (CONTROLLED) TACTILE PAVING
- ▨ PROPOSED BUFF (UNCONTROLLED) TACTILE PAVING
- ▨ PROPOSED SHARED USE PATH
- ▨ PROPOSED SEGREGATED CYCLEWAY
- ▨ PROPOSED WIDENING OR NARROWING OF EXISTING FOOTWAY
- ▨ PROPOSED TRAFFIC ISLAND
- ▨ EXISTING SHARED USE PATH TO BE RETAINED
- ▨ EXISTING FOOTWAY TO BE RETAINED
- ▨ EXISTING CARRIAGEWAY
- ▨ PROPOSED RAISED TABLE
- ⊙ AREA OF PLACEMAKING OPPORTUNITY

REV	DATE	BY	DESCRIPTION	CHK	APP
P09	02/12/2025	KT	DESIGN UPDATES	JK	PJ
P08	15/10/2025	KT	DRP ISSUE	JK	PJ
P07	15/09/2025	JK	UPDATED FOLLOWING CLIENT COMMENT	PJ	PJ
P06	12/09/2025	VC	UPDATED FOLLOWING CLIENT COMMENT	JK	PJ
P05	04/07/2025	KT	UPDATED FOLLOWING INTERNAL DRP	JK	PJ
P04	09/06/2025	KT	UPDATED FOLLOWING DRP COMMENT	JK	PJ
P03	21/02/2025	JK	UPDATED FOLLOWING CLIENT COMMENT	PJ	PJ
P02	20/12/2024	JK	UPDATED FOLLOWING CLIENT COMMENT	PJ	PJ
P01	04/12/2024	VG	FIRST ISSUE	JK	PJ

DRAWING STATUS: S2 - FOR INFORMATION



The Mailbox, Level 2, 100 Wharfside Street, Birmingham, B1 1RT, UK
T+ 44 (0) 121 352 4700, F+ 44 (0) 121 352 4701
wsp.com



SITE PROJECT: BURY ACTIVE TRAVEL
CONCEPT DESIGN DEVELOPMENT

TITLE: BURY TOWN CENTRE
CHAMBERHALL STREET TO CHARLES STREET
CYCLE IMPROVEMENTS
SHEET 05 OF 05

SCALE @ A1: 1:500	CHECKED: JK	APPROVED: PJ
PROJECT NO: UK0028352.8493	DESIGNED: KT	DRAWN: VC
		DATE: December 25
DRAWING NO: 28352.8493-WSP-XX-WG-DR-LP-0005		REV: P09

© WSP UK Ltd

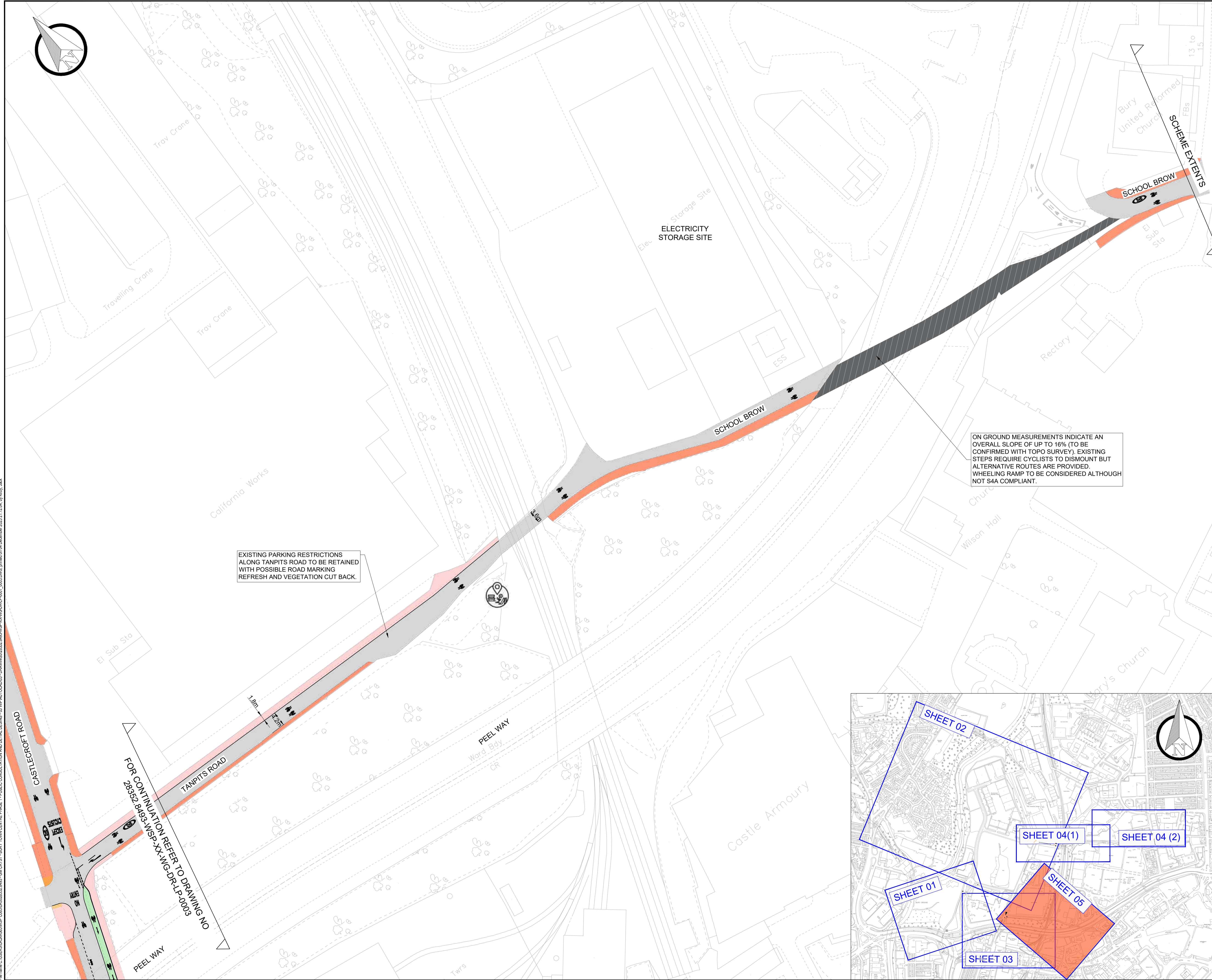

ON GROUND MEASUREMENTS INDICATE AN OVERALL SLOPE OF UP TO 16% (TO BE CONFIRMED WITH TOPO SURVEY). EXISTING STEPS REQUIRE CYCLISTS TO DISMOUNT BUT ALTERNATIVE ROUTES ARE PROVIDED. WHEELING RAMP TO BE CONSIDERED ALTHOUGH NOT S4A COMPLIANT.

EXISTING PARKING RESTRICTIONS ALONG TANPITS ROAD TO BE RETAINED WITH POSSIBLE ROAD MARKING REFRESH AND VEGETATION CUT BACK.

FOR CONTINUATION REFER TO DRAWING NO 28352.8493-WSP-XX-WG-DR-LP-0003

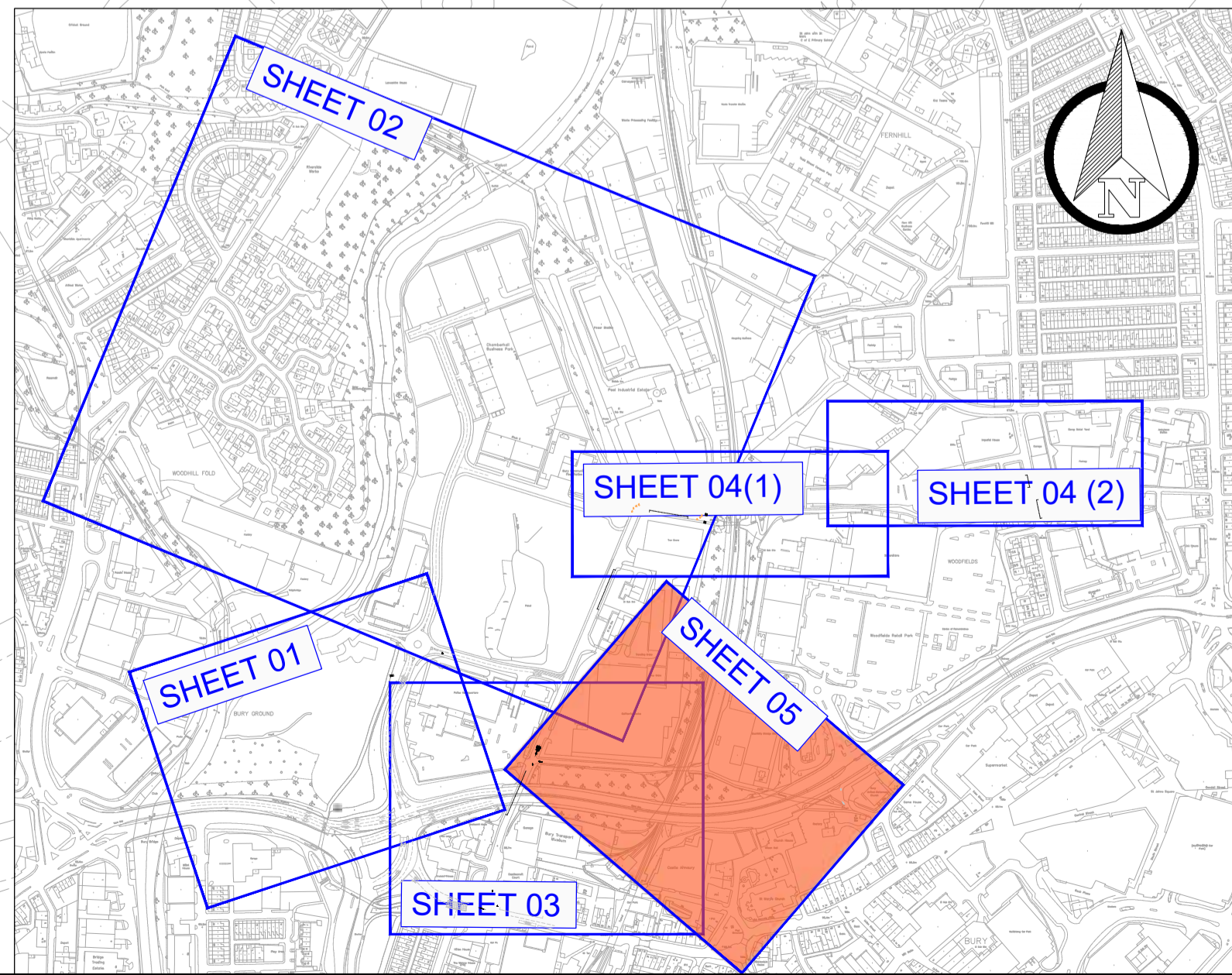

File name: C:\Users\uk006591\OneDrive\Documents\Bury Town Centre Phase 1 - Public Consultation and Detail Design - Bury Town Centre Phase 1 - Public Consultation and Detail Design - 0035.DWG, printed on 04 December 2025, 21:12:04, by kctv_jak