

DO NOT SCALE

NOTES:

1. ALL DIMENSIONS GIVEN ARE SHOWN IN METRES UNLESS OTHERWISE SPECIFIED.
2. CONCEPT DESIGN HAS BEEN COMPLETED BASED ON OS MAPPING AND SITE OBSERVATIONS ONLY. DESIGN SUBJECT TO CHANGE UPON TOPOGRAPHICAL AND OTHER SURVEY INFORMATION ACQUISITION AS DESIGN MOVES TO NEXT STAGE.
3. TRAFFIC MODELING NOT YET UNDERTAKEN.
4. REFRESH OF EXISTING ROAD MARKINGS, FORMALISED PARKING BAYS, TROS AND TACTILE PAVING TO BE ASSESSED AT A LATER DESIGN STAGE.

KEY:

- EXISTING KERB LINE
- EXISTING ROAD MARKING
- PROPOSED KERB LINE
- PROPOSED WHITE LINE MARKING
- PROPOSED WHITE LINE MARKING / DEMARCATION BLOCKS TO PROVIDE SEGREGATION BETWEEN CYCLISTS / PEDESTRIANS
- PROPOSED TRAMLINE PAVING
- PROPOSED LADDER PAVING
- PROPOSED RAMP
- PROPOSED RED (CONTROLLED) TACTILE PAVING
- PROPOSED BUFF (UNCONTROLLED) TACTILE PAVING
- PROPOSED SHARED USE PATH
- PROPOSED SEGREGATED CYCLEWAY
- PROPOSED WIDENING OR NARROWING OF EXISTING FOOTWAY
- PROPOSED TRAFFIC ISLAND
- EXISTING SHARED USE PATH TO BE RETAINED
- EXISTING FOOTWAY TO BE RETAINED
- EXISTING CARRIAGEWAY
- EXISTING VERGE AREA
- PROPOSED RAISED TABLE
- AREA OF PLACEMAKING OPPORTUNITY

REV	DATE	BY	DESCRIPTION	CHK	APP
P04	05/12/2025	KT	DESIGN UPDATES	JK	PJ
P03	15/10/2025	KT	DRP ISSUE	JK	PJ
P02	15/09/2025	KT	UPDATED FOLLOWING CLIENT COMMENT	JK	PJ
P01	12/09/2025	VC	ROUTE EXTENT UPDATED	JK	PJ

DRAWING STATUS: S2 - FOR INFORMATION

wsp
The Mailbox, Level 2, 100 Wharfside Street, Birmingham, B1 1RT, UK
T+ 44 (0) 121 352 4700, F+ 44 (0) 121 352 4701
wsp.com

Bury COUNCIL

SITE/PROJECT: BURY ACTIVE TRAVEL CONCEPT DESIGN DEVELOPMENT
TITLE: BURY TOWN CENTRE JUBILEE WAY TO BOLTON STREET CYCLE IMPROVEMENTS SHEET 03 OF 03

SCALE @ A1: 1:500	CHECKED: JK	APPROVED: PJ
PROJECT NO: UK0028352.8493	DESIGNED: JK	DRAWN: VC
		DATE: December 25

DRAWING NO: 28352.8493-WSP-XX-SG-DR-LP-0003	REV: P04
---	----------

© WSP UK Ltd

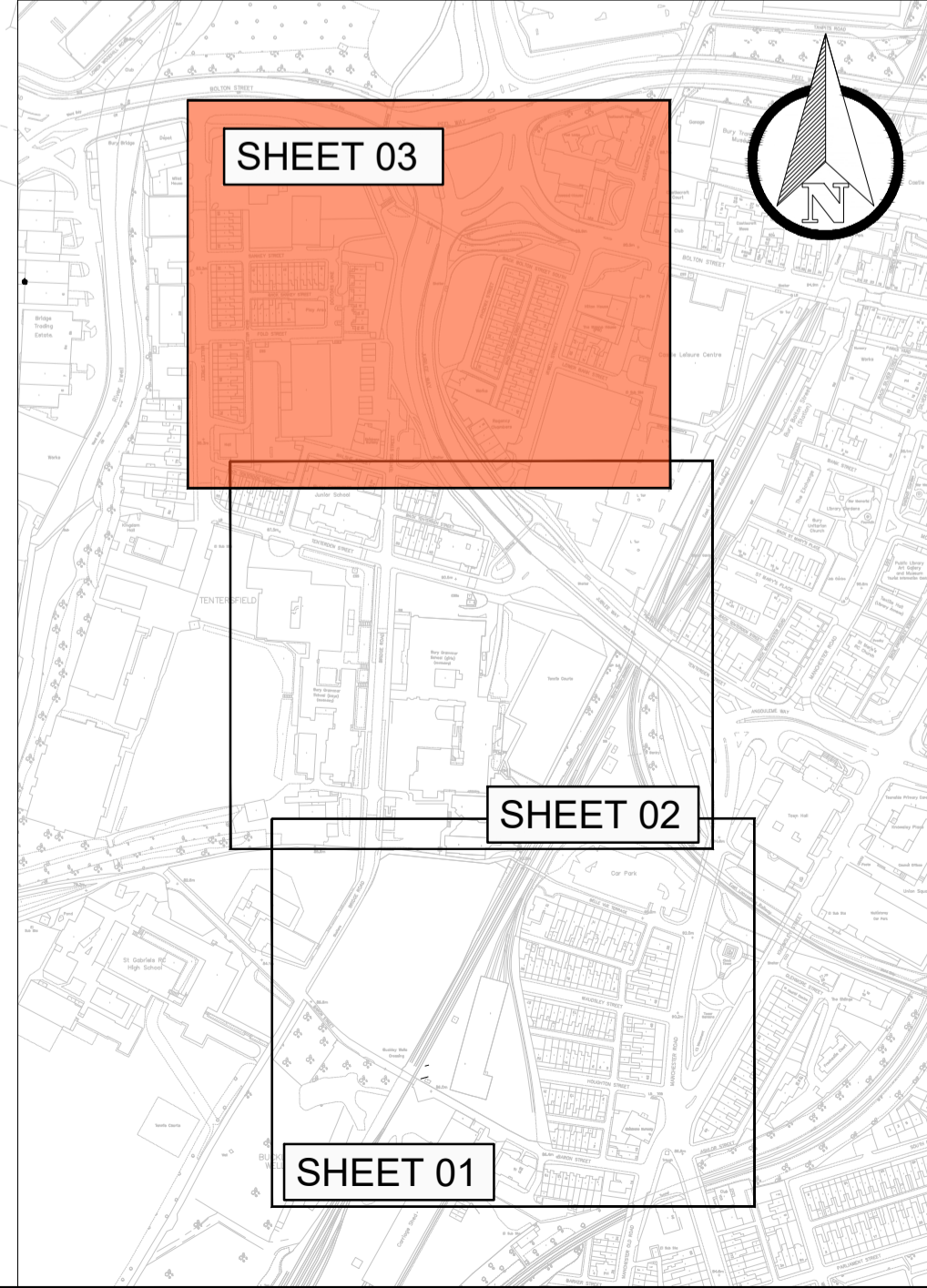
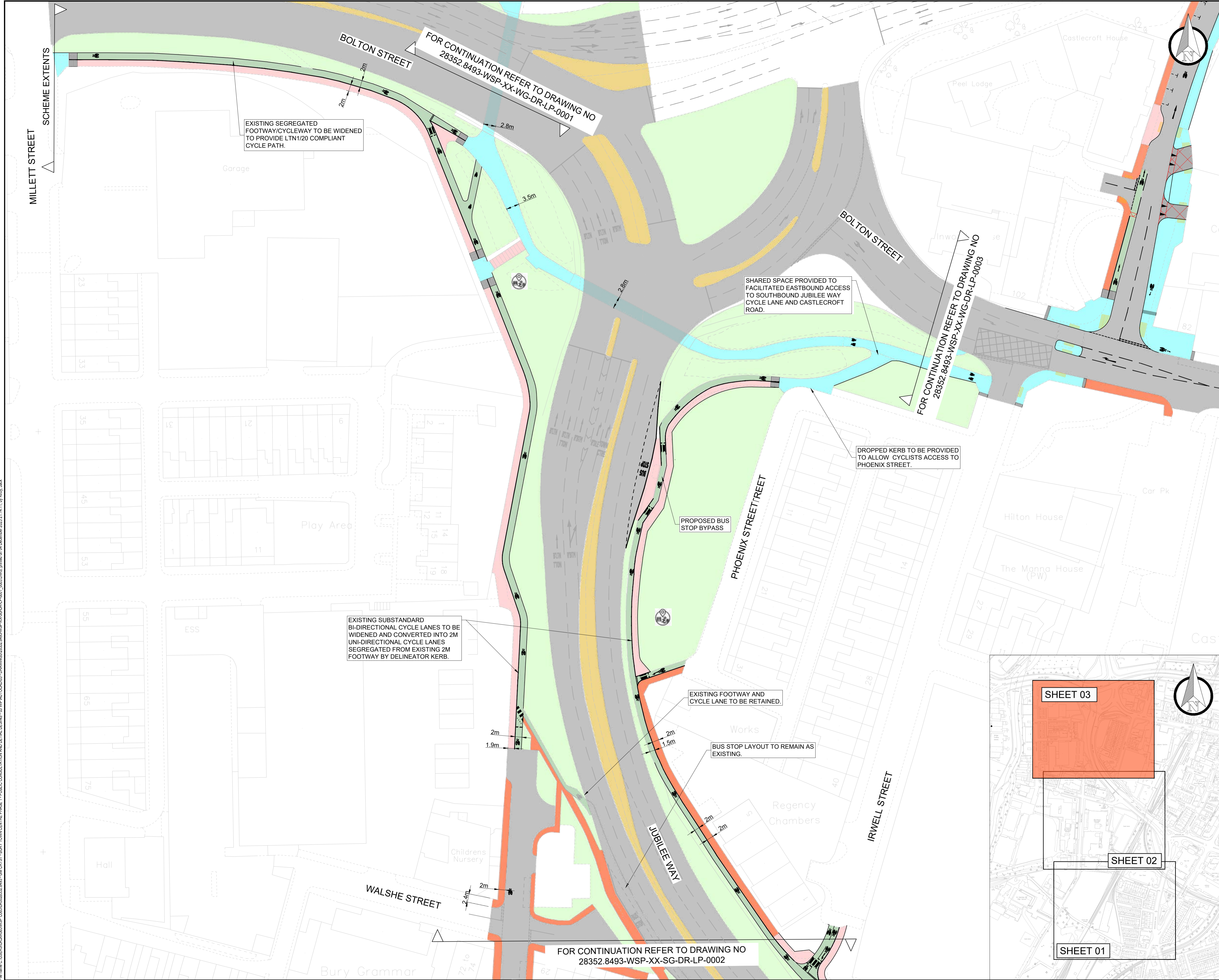

File name: C:\Users\uk008591\OneDrive\Documents\Bury\Bury Active Travel\Bury Town Centre\Bury Town Centre Cycle Improvements\28352.8493-WSP-XX-SG-DR-LP-0003.dwg, printed on 04 December 2025 21:14:11, by KChy, jck